

TIPO - TYPE		P ₂ nom.		P ₁ (kW) max.		AMPERE		Q = portata - débit - capacity - Fördermenge - portata															
1 ~	3 ~	HP	kW	1 ~	3 ~	1 ~	3 ~	Prevalenza manometrica totale in m. C.A. Hauteur manométrique totale en m. - Total head in meters w.c. Förderhöhe m. - Altura de impulsión manométrica total en m.															
230 V	230/400 V							1 x 230 V	3 x 400 V	m ³ /h	0	1.5	3	4.5	6	7.5	9	10,5	12	15	18	24	30
						l/l'	0	25	50	75	100	125	150	175	200	250	300	400	500	600			
CB 100	CBT 100	1	0.74	1.17	1.15	5.4	2.4	44	41.5	37	22.5												
CB 160	CBT 160	1.5	1.1	2.30	2.20	10.2	4.1	53	51	48	44	40											
CB 210	CBT 210	2	1.5	2.60	2.45	11.5	4.8	58	56	53	49	44	38										
-	CBT 310	3	2.2	-	2.80	-	5.2	64	62	59	55	50	43	37									
CB 400	CBT 400	4	3	4.35	4.5	21.5	7.6	66.9	63.9	63.3	61	58.4	55.2	51.5	47.8	44.2							
CB 600	CBT 600	5.5	4	5.6	5.45	27	9.5	78.7	77.1	76.1	74.6	72	69.4	66	62.4	58.7							
-	CBT 750	7.5	5.5	-	8.1	-	14.7	90	89	88.6	87	84.8	82.3	79.2	76.3	72.5	62.7						

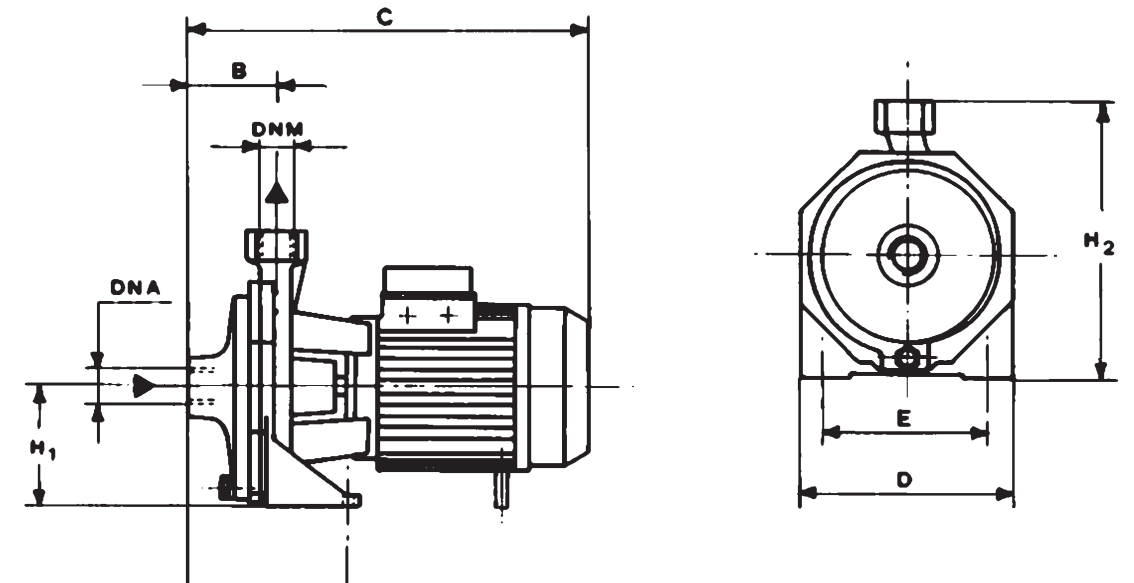

TIPO TYPE	Dimensioni mm Dimensions mm Dimensions mm Masstabelle mm Dimensiones mm										Dimensioni imballo mm Dimensions d'emballage mm Packing dimensions mm Verpackungsmasse mm Dimensiones embalaje mm			Peso Poids Weight Gewicht Peso
	A	B	C	D	E	H1	H2	DNA	DNM	I	L	M	Kg	
CB 100	122	73	328	180	140	98	228	1"G	1"G	350	195	265	15.3	
CB 160	115	81	385	210	170	110	265	1"1/4G	1"G	405	225	295	24	
CB 210	115	81	385	210	170	110	265	1"1/4G	1"G	405	225	295	23.4	
CB 310	115	81	385	210	170	110	265	1"1/4G	1"G	405	225	295	23.4	
CB 400	145	95.5	463	266	212	135	305	1"1/2G	1"1/4G	500	275	350	41	
CBT 600	145	95.5	463	266	212	135	305	1"1/2G	1"1/4G	500	275	350	44.8	
CBT 750	145	95.5	480	266	212	135	305	1"1/2G	1"1/4G	500	275	350	50.5	

